

# **LOW-VOLTAGE SWITCHBOARDS rated up to 1000 V**

## **Assembly, operation and maintenance instructions**

### **AX, KX type distribution box (wall-mounted surface type ASSEMBLY)**

## **CONTENTS:**

<b>1. Labelling</b>	<b>3</b>
<b>2. Basic technical data</b>	<b>3</b>
<b>3. Equipment description</b>	<b>3</b>
<b>4. Equipment, control elements</b>	<b>3</b>
<b>5. Important features</b>	<b>3</b>
<b>6. Mode adjustment</b>	<b>3</b>
<b>7. Packing, Transport, Storage</b>	<b>4</b>
<b>8. Switchboard installation</b>	<b>4</b>
<b>9. Operation and Maintenance</b>	<b>5</b>
<b>10. Inspections</b>	<b>5</b>
<b>11. Service inspections</b>	<b>6</b>
<b>12. Maintenance plan</b>	<b>6</b>
<b>13. Surrounding environment</b>	<b>6</b>
<b>14. Turning OFF a circuit using a safety element</b>	<b>6</b>
<b>15. Reserves</b>	<b>7</b>
<b>16. Defective instruments</b>	<b>7</b>
<b>17. Operation interruption and switchboard shutdown</b>	<b>7</b>
<b>18. Prohibited tampering and handling</b>	<b>7</b>
<b>19. Switchboard accessories</b>	<b>7</b>

## 1. Labelling

Each switchboard is fitted with a **product specification label** as required by ČSN (EN, IEC, HD), located inside on doors in the first field in the corner opposite to the door lock.

## 2. Basic technical data

Delivered switchboards **comply** with technical specifications provided by the Client for each individual order. Power grid of individual and delivered switchboards complies with the relevant order and with ČSN 33 2000-1 ed. 2 (idt HD 60364-1:2008, mod IEC 60364-1:2005).

All **basic information** relevant to a particular switchboard are available in the technical /manufacturing documentation on the **relevant drawing** - front view and in a summarized table providing information about interface and about basic parameters of the switchboard (type of the switchboard, protection class, dimensions, paint specification, power grid, electrical current, insulation voltage, safety, environment, and possibly also additional information).

## 3. Equipment description

Individual switchboards are assembled according to project documentation. **Instrument layout** in relevant switchboard was designed in order to allow connection of inlet and outlet cables. Cables run through the upper wall or bottom - based on requirements.

Delivered switchboards comply with **protection class** IP40 or IP55 (based on specifications), and after doors are open with protection class IP00 or IP20.

**Capacitive / capacitor switchboards** are fitted with control regulators. Individual branches are equipped with safety features, a switching element, and if compensation is protected with chokes, with own capacitor and with discharge resistors.

## 4. Equipment, control elements

**Complete specification** of used instruments is available in the technical / manufacturing documentation of individual switchboards - on diagrams depicting individual fields.

## 5. Important features

Great emphasis has been put on **correct operation** of safety circuits in order to ensure trouble-free operation and safety of operating personnel. Correct functions of safety circuits were tested in the manufacturing plan. It is recommended to repeat these tests before putting the switchboard in operation.

## 6. Mode adjustment

**Selectivity** of individual circuits must be tested and adjusted before switchboards are put into operation by the installation company.

**Electrical current value** settings on safety elements (if such setting applies) must be adjusted by the installation company according to special needs.

Before **compensating switchboards** are put into operation, the reactive power of the control regulator must be set first according to operator's requirements. When adjusting control regulator, instructions specified in the attached manual must be observed.

All above settings or any other settings must be tested during a test operation and corrections must be applied if necessary.

## 7. Packing, Transport, Storage

Switchboards are **wrapped** with a transparent PVC foil. This packaging method does not provide any protection against harmful weather conditions. When shipped via trucks or railroad, switchboard must always be covered by canvas. Sea shipment requirements or any other packaging requirements may be done after an agreement.

Equipment may be set down only on an even surface.

Switchboards must be **stored** in dry and dust free rooms and protected from incidental damages. Temperature between  $-10\text{ }^{\circ}\text{C}$  and  $+35\text{ }^{\circ}\text{C}$ , relative humidity up to 80 % at  $21\text{ }^{\circ}\text{C}$ . Switchboards cannot be stored in humid rooms or spaces which are still under construction.

## 8. Switchboard installation

Switchboards shall be installed in dry and clean rooms, free of any construction works.

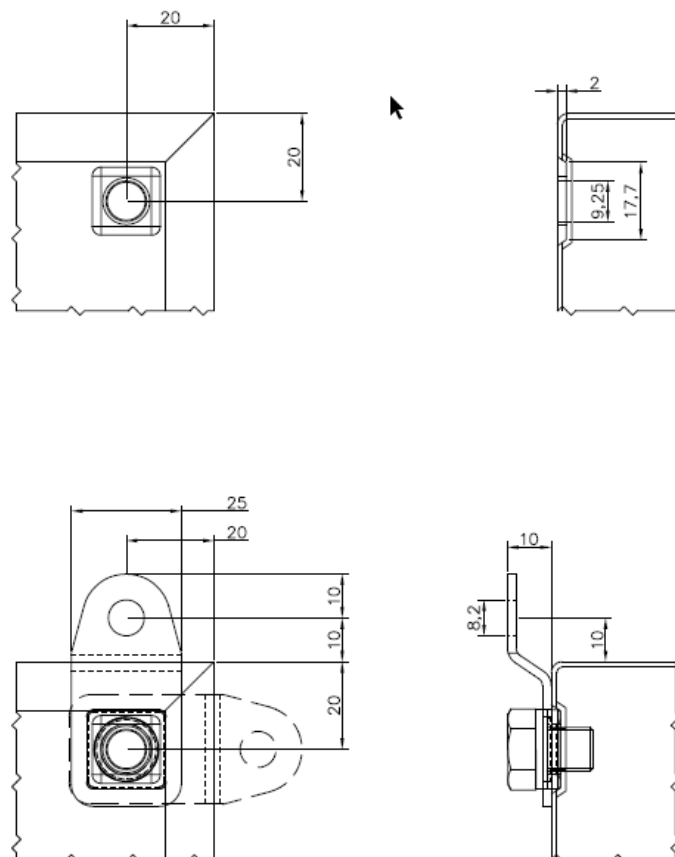

Tightening torques for instruments are specified in manuals provided by manufacturers of the relevant instruments.

**Width of corridors** and access spaces must be sufficient to perform the relevant work, to allow operation, to provide access in case of emergencies and to accommodate transportation as specified (for example in ČSN 33 2000-7-729, mod IEC 60364-7-729:2007, idt HD60364-7-729:2009).

**All screw / bolt couplings must be properly tightened.**

When connecting the external cabling, always pay attention to the correct fastening and arrangement of the cables leading into the switchboard and perform their routing and forming in the switchboard so as not to obstruct the access to the PEN, PE and N conductor bars, which must remain freely accessible for inspections and controls of the external cabling connection points on those conductor bars.

Before a switchboard is put into operation it must be tested pursuant to (EN, IEC, HD) and according to instructions specified in this manual.

## 9. Operation and Maintenance

Safe operation of switchboard requires operators and maintenance personnel to observe valid norms and regulations (including requirements of suppliers of individual instruments). Persons authorized to operate and maintain the equipment must learn about these standards and regulation - especially provisions specified in ČSN EN 50110-1 ed. 3 (EN 50110-1:2013).

**Unauthorized persons cannot be allowed** to use or handle switchboards.

Qualification requirements for persons operating switchboards are specified under ČSN EN 50110-1 ed. 3 (EN 50110-1:2013) and protection classes (protection class applies to the entire switchboard and when switchboard doors are opened). If there are different qualification requirements on operating personnel, they must be described in the local operation guideline. Under **no circumstances** the qualification level may be lower than the qualification level for which the switchboard was ordered and manufactured.

Switchboards may be operated **only when doors are closed** (if switchboard is fitted with doors).

## 10. Inspections

**Switchboards** must be regularly inspected and revised. This applies mostly to main and control circuits. Special attention must be paid to **protection / safety circuits**.

**Visual inspection** must be performed after one week of operation. **Additional inspections** shall be done based on maintenance plan prepared according to valid regulations.

Switchboard manufacturer recommends performing inspection using **thermal imaging** at least once a year **and once every 4 years** inspection of couplings, unless the manufacturer of installed instruments recommends more frequent inspections.

Additional inspection dates shall be specified in the inner regulations of the operator.

**Compensation switchboard** power couplings suffer impact loads and therefore it is recommended to inspect power couplings before the switchboard is put into operation and then again **once a year**.

Inspections must also include **visual checks** focusing on conditions of individual instruments as well as cleaning of inner sections of the switchboard. During a revision inner spaces must be cleaned.

In case of continuous and long operation regular **measurements** must be performed and surface **temperature** on circuit breaker cover above switching contacts must be recorded.

When performing revisions, it is necessary **to turn ON and OFF** several times switching elements, which have been in one position for long time, in order to break possible oxidation layers which may have accumulated on contacts.

Detected defects must be removed properly and in timely manner.

## **11. Service inspections**

**Service inspections** and checks focusing on functionality of safety and protection elements (circuit breakers, motor starters, covers etc.) should be done by qualified service technician.

Service inspections may be ordered at the manufacturer.

## **12. Maintenance plan**

The operator is obligated to produce a **maintenance plan**, which must be properly introduced to authorized employees (within the scopes of their authorities).

Performed inspections, maintenance services, shutdown of protection elements due to short-circuits done by maintenance personnel, fuse and instrument replacements must be recorded in a **maintenance book**. These records must be presented to component suppliers or switchboard manufacturer upon request.

The above specified inspections/checks do not replace regular inspection plan applicable to individual switchboards produced by the operator.

## **13. Surrounding environment**

Basic characteristics of supplied switchboards comply with ČSN 33 2000-5-51 ed. 3 (idt HD 60364-5-51:2009 + idt HD 60364-5-51:2009/A11:2013 + idt HD 60364-5-51:2009/A12:2017, mod IEC 60364-5-51:2005) AA4, which means that temperature of the **surrounding air cannot** exceed 40 °C, and average temperature during 24 hours cannot exceed 35 °C. Operational conditions of the switchboard comply with ČSN EN 61439-1 ed.3 Article 7.1.2 (idt IEC 61439-1:2020 + IEC 61439-1:2020/Cor1:2021-12) and corresponds with the level of pollution specified in manufacturing documentation.

## **14. Turning OFF a circuit using a safety element**

**When a circuit is turned off** by a fuse or a safety element the cause for this situation must be determined and repaired. Only then the switchboard may be turned ON again. The same requirement applies to a situation when overload is detected. Contacts of safety and protection elements which were turned OFF by overcurrent or by short-circuit must be inspected.

## 15. Reserves

Reserves which are installed in individual switchboards are based on project requirements and may be used up to the values their equipped with. Pursuant to item 17 of these instructions, reserves **cannot** be replaced with instruments with higher values.

## 16. Defective instruments

**Defective instruments** must be replaced with perfect instruments with the same parameters (new or repaired by the manufacturer of the relevant instrument).

## 17. Operation interruption and switchboard shutdown

When switchboard is **shut down** and before it may be turned ON back again it is necessary to inspect the entire switchboard (conditions of individual instruments, their settings, coupling conditions, and in particular status of protection circuits, etc.).

**During short-term interruptions** (for example when a defect is being removed) the switchboard may be turned ON again after the performed work is properly inspected and after protection circuits are checked.

## 18. Prohibited tampering and handling

**No** instruments in switchboards may be **added**, and **no** defective instruments may be repaired, in particular fuses and safety elements. Instruments may only be replaced with a new one or repaired by the manufacture of the relevant instruments.

Used instruments **cannot be replaced with instruments with higher values/ratings**.

Switchboards cannot be operated under different conditions than for which they have been designed (other voltage and electrical current values, surrounding temperatures, other environment in terms of protection class, mechanical damages).

If a switchboard is under current, no metal or wet tools/objects may be used or handled inside the switchboard.

Requirements specified in ČSN 33 2000-4-41 ed.3 (eqv HD 60364-4-41:2007 apply to switchboard access restrictions and mod IEC 60364-4-41:2005 + mod IEC 60364-4-41:2005/A1:2017) applies to protection against injury by electric shock.

## 19. Switchboard accessories

1 key for door lock type DOPPELBART 5 mm, or 3524 for safety insert.

Instruction and maintenance manuals for installed components (standard delivery provided by manufacturers of the relevant components, which includes safety elements, frequency inverters, power circuit breakers, contactors, ..... etc.